

GRX Crankset

FC-RX810-11-1
FC-RX810-11-2

FC-RX810-11-1-LE
FC-RX810-11-2-LE

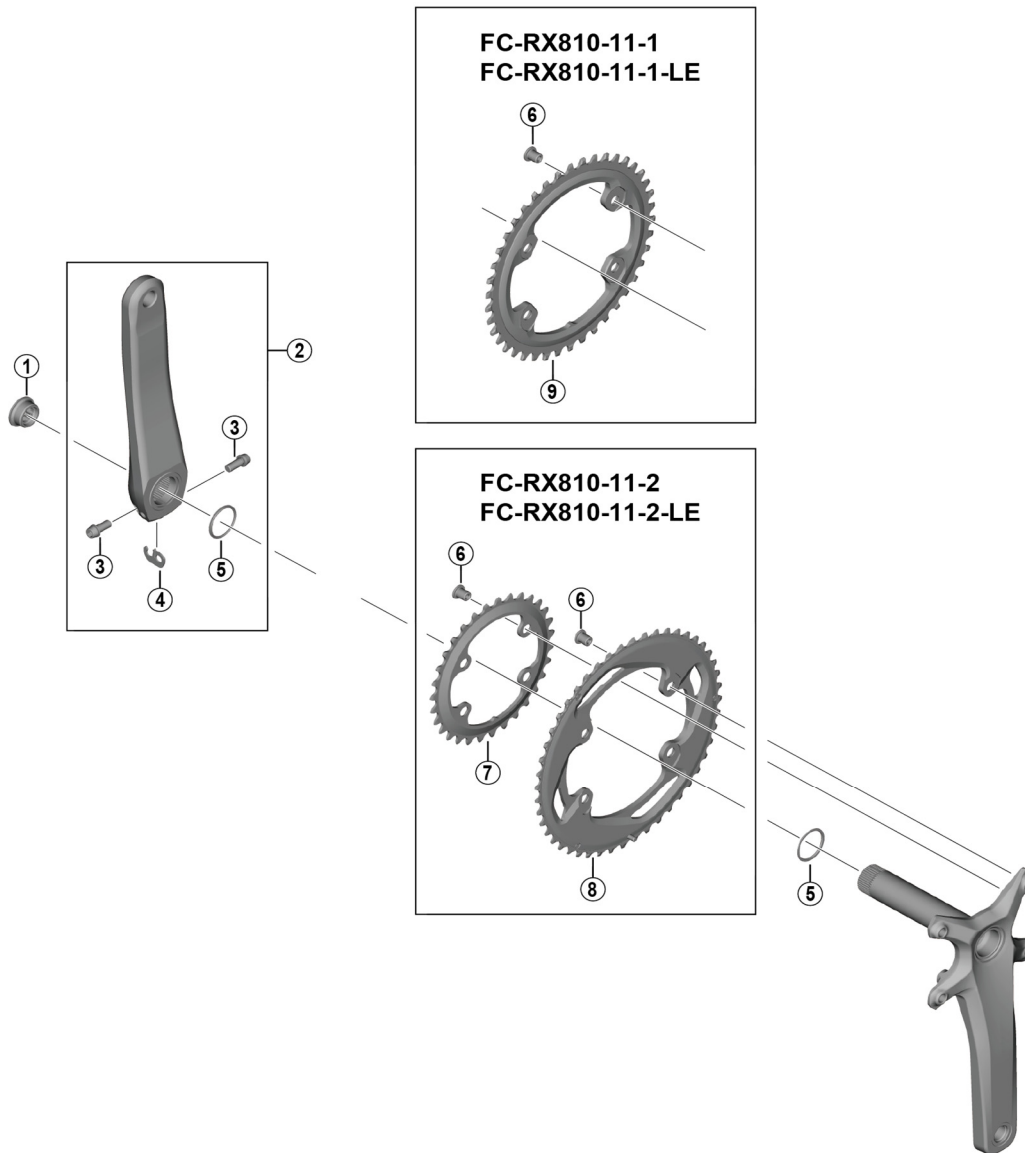

Note

There are no specific service parts for FC-RX810-11-1-LE/FC-RX810-11-2-LE.

FC-RX810-11-1/FC-RX810-11-2 service parts can be used for FC-RX810-11-1-LE/FC-RX810-11-2-LE.

• **Chainring teeth specification: 48-31T / 42T / 40T**

• **P.C.D. 110 mm (for outer chainring), 80 mm (for inner chainring)**

ITEM NO.	SHIMANO CODE NO.	DESCRIPTION	INTERCHANGEABILITY	
			FC-RX810-11-1-LE	FC-RX810-11-2-LE
1	Y0J620000	Crank arm fixing screw	A	A
2	Y0JR98020	Left hand crank arm unit 170 mm	B	B
	Y0JR98030	Left hand crank arm unit 172.5 mm	B	B
	Y0JR98040	Left hand crank arm unit 175 mm	B	B
3	Y1GS22000	Clamp screw with washer (M6 x 19)	A	A
4	Y1GE98050	Plate	A	A
5	Y1F316000	Ring	A	A
6	Y0JR98050	Chainring fixing screw (M8 x 9 / 1 unit = 4 pcs.)	A	A
7	Y0JR31000	Chainring 31T-ND		A
8	Y0JR98010	Chainring 48T-ND		B
9	Y0JP98010	Chainring 40T	B	
	Y0JP98020	Chainring 42T	B	

A: Same parts.

B: Parts are usable, but differ in materials, appearance, finish, size, etc.

Absence of mark indicates non-interchangeability.

Specifications are subject to change without notice.

Jun.-2022-4586B

© Shimano Inc. I

SHIMANO