

Cassette (9-speed)
CS-HG201-9 bo/bn/bw-Group

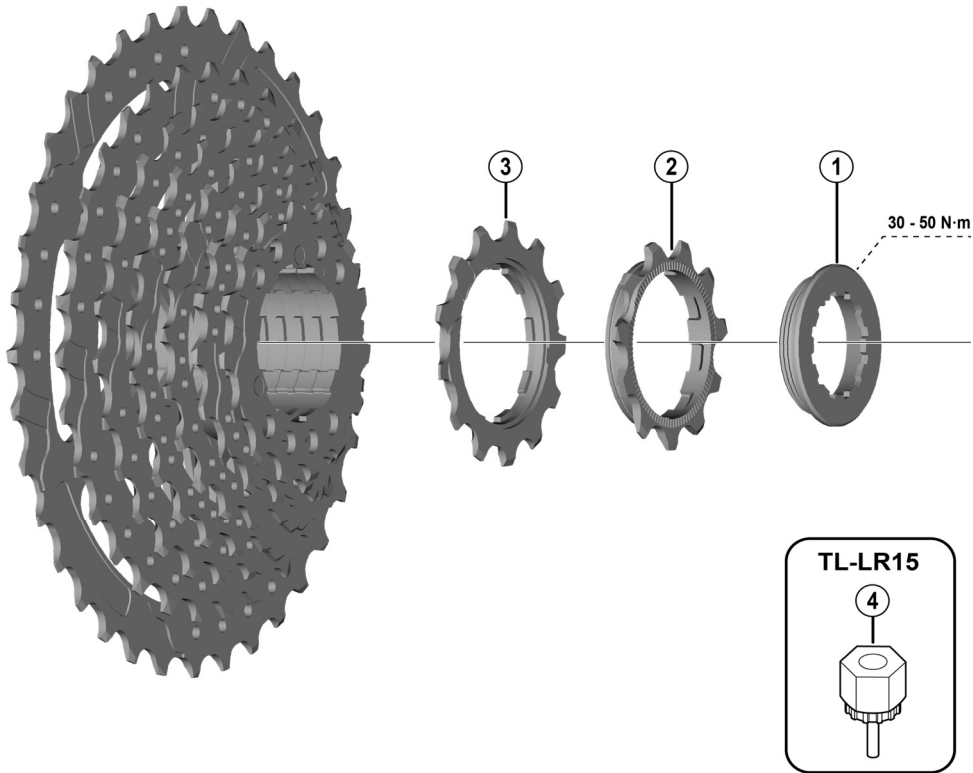

- bo-group sprocket teeth combination: 11-13-15-17-19-21-24-28-32T
- bn-group sprocket teeth combination: 11-13-15-17-20-23-26-30-34T
- bw-group sprocket teeth combination: 11-13-15-17-20-23-26-30-36T

CS-HG200-9

ITEM NO.	SHIMANO CODE NO.	DESCRIPTION	INTERCHANGEABILITY	
* 1	Y11E01300	Lock ring	A	
2	Y1Y711000	Sprocket 11T (built in spacer type)	A	
3	Y1WL00010	Sprocket 13T (built in spacer type)	B	
4	Y12009230	Lock ring removal tool (TL-LR15)	A	

A: Same parts.

B: Parts are usable, but differ in materials, appearance, finish, size, etc.

Absence of mark indicates non-interchangeability.

Specifications are subject to change without notice.

Torque information is listed.

Jun.-2023-4273A

© Shimano Inc. I

SHIMANO