

SLX Crankset

FC-M7100-1 FC-M7100-2
BB-MT801 BB-MT800 SM-CRM75

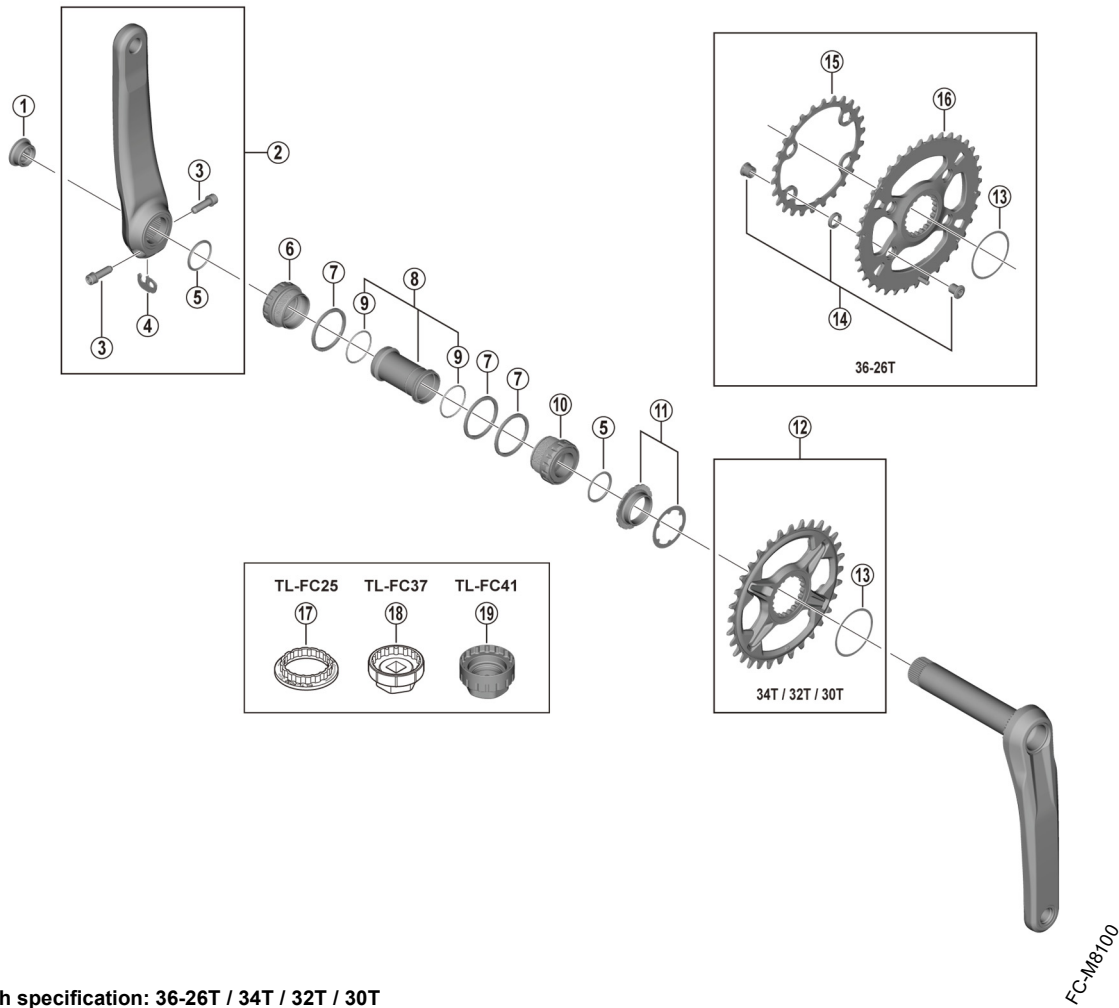

• **Chainring teeth specification: 36-26T / 34T / 32T / 30T**

ITEM NO.	SHIMANO CODE NO.	DESCRIPTION	INTERCHANGEABILITY
1	Y0J620000	Crank arm fixing screw	A
2	Y0J998010	Left hand crank arm unit 165 mm	
	Y0J998020	Left hand crank arm unit 170 mm	
	Y0J998030	Left hand crank arm unit 175 mm	
3	Y1GS21000	Clamp screw with washer (M6 x 21)	A
4	Y0J698050	Plate	A
5	Y1F316000	Ring	A
* 6	Y2LC98010	Left hand cup (B.C.1.37" x 24T) english thread (BB-MT801)	A
	Y1V698010	Left hand cup (B.C.1.37" x 24T) english thread (BB-MT800)	A
7	Y1P804000	Spacer (2.5 mm)	A
8	Y1E598210	Inner cover and O-ring	A
9	Y1TF21000	O-ring	A
* 10	Y2LC98020	Right hand cup (B.C.1.37" x 24T) english thread (BB-MT801)	A
	Y1V698020	Right hand cup (B.C.1.37" x 24T) english thread (BB-MT800)	A
11	Y0J698060	Lock ring and washer	A
12	ISMCRM75A0	Chainring 30T with spacer (SM-CRM75)	
	ISMCRM75A2	Chainring 32T with spacer (SM-CRM75)	
	ISMCRM75A4	Chainring 34T with spacer (SM-CRM75)	
13	Y0JC61000	Spacer	A
14	Y0JB98020	Chainring fixing bolt unit (4 sets)	
15	Y0JB26000	Chainring 26T-BJ for 36-26T	
16	Y0JB98010	Chainring 36T-BJ for 36-26T	B
17	Y13009260	TL-FC25 Bottom bracket cup tool	
18	Y13009270	TL-FC37 Bottom bracket cup tool	
19	Y13098720	TL-FC41 Front chainring direct mount tool	

A: Same parts.

B: Parts are usable, but differ in materials, appearance, finish, size, etc.

Absence of mark indicates non-interchangeability.

Specifications are subject to change without notice.

Oct.-2022-4599B

© Shimano Inc. I

SHIMANO